

# E3 Gate valve | Combi valves



## Overview

### Design features

- Resilient seated gate valve according to EN 1171, EN 1074-1 and EN 1074-2 with smooth, straight-through bore
- Double bayonet O-ring carrier is connecting the spindle to the bonnet, allowing a fully encased, uniform epoxy powder coated bonnet for further improved corrosion protection
- Wedge guide made of wear resistant POM material in load optimized design minimizes attrition and ensures lowest torque actuation
- Wedge is flexible and fully linked in vulcanized elastomer to the wedge nut. This snug fit dampens vibration during opening and closing of the wedge
- Wedge nut has a long thread length allowing significantly higher torques than the standard before breaking
- O-rings, lip-seals mounted in the bonnet are replaceable under operating pressure
- Extended edge protection to avoid damages during transport, storage and assembly
- Sliding disks and ball bearing assure low friction performance of the spindle
- 100% suitable for buried installations

### Material | Technical features

- 1,2 Body (1), bonnet (2), centering flange (16) made of ductile iron,
- 16 epoxy powder coated inside and out
- 3 Wedge made of ductile iron (DN 50 made of dezincification-resistant brass) with vulcanized elastomer all-over
- 4 Wedge guide made of wear-resistant plastic
- 5 Wedge nut made of dezincification-resistant brass
- 6 Duplex stainless steel spindle with rolled thread and flat-rolled anti-friction surface
- 7 O-ring carrier made of brass, DN 50 – 200 with double bayonet
- 8 O-rings made of elastomer
- 9 Wiper ring made of PE
- 10 Bonnet gasket made of elastomer
- 11 Allen screws made of stainless steel, encased into the body with interlacing gasket and sealing compounds, ensuring full corrosion protection
- 12 Extended edge protection made of PE
- 13 Spindle bearing made of dezincification resistant brass
- 14 Sliding disks made of POM
- 15 Safety screw made of stainless steel
- 17 Centering flange gasket made of elastomer
- 18 Axial ball bearing permanently lubricated
- 19 Centering ring made of POM
- 20 Lip seals made of elastomer
- 21 Wiper ring made of elastomer

### DN 50 – 200

Spindle bearing with sliding disks

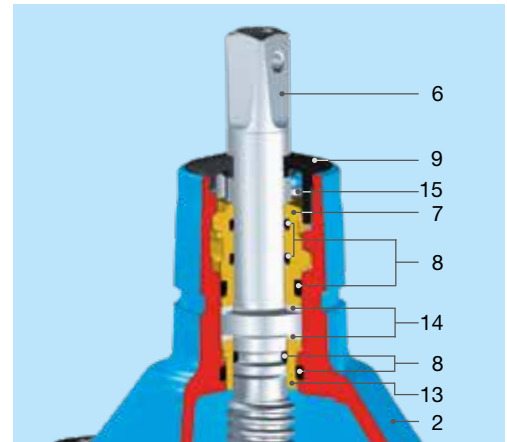

### DN 250 – 600 Spindle bearing with ball bearing and additional sliding disks

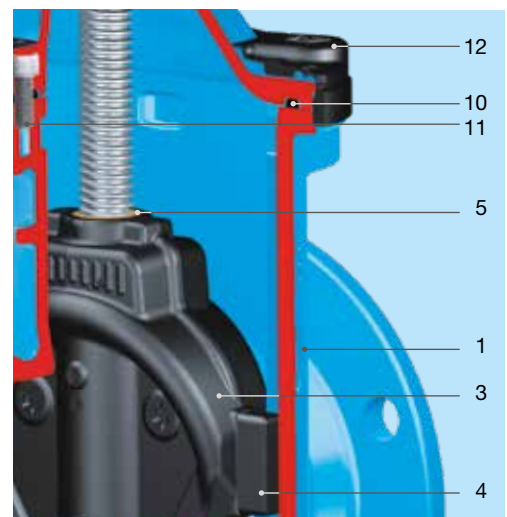
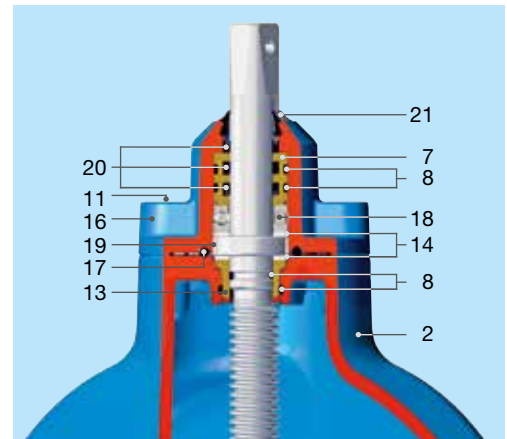

# E3 Gate valve

With flange DN 50 – 200, PN 10 | PN 16 | PN 25

## Design features

- Resilient seated gate valve with smooth straight-through bore
- Flanges sized in accordance with EN 1092-2, drilled according to  
EN 1092-2 | PN 10 standard (4000E3, 4700E3);  
EN 1092-2 | PN 16 from DN 200 (4000E3, 4700E3)  
EN 1092-2 | PN 25 (4010E3, 4710E3)  
Please specify on order - other standards on request
- Suitable for cleaning with a cleaning pig
- One extension spindle for several dimensions
- Suitable for operation by automatic actuators
- Easy retrofitting of position indicator and automatic actuators on the standard bonnet
- Duplex stainless steel spindle

**Standard version:** without handwheel and extension spindle

**Design versions:**

for actuator:	No. 4000ELE3
with actuator:	No. 4000EME3
with position indicator:	No. 4000STE3
for seawater:	No. 4002E3, No. 4702E3

**Special versions:** on request

No. 4000E3

No. 4700E3

No. 4010E3

No. 4710E3

No. 4060E3



## Suitable accessories

**Suitable accessories:** see page A 2/2

Handwheel:		No. 7800
Extension spindles:	rigid	No. 9000E2/E3
	telescopic	No. 9500E2/E3
Surface boxes:	rigid	No. 1750
	telescopic	No. 2050
		No. 2051K
Valve actuator:		No. 9920
Adapter for actuator (E2/E3 adapter):		No. 8630E2/E3
Base plate:	No. 3481, No. 3482	
Operating cap:	No. 2156, No. 2157	
Extension spindle:	No. 7820, No. 7825	
Position indicator:	No. 2170E2/E3	
Bolts:	No. 8810, No. 8830, No. 8840	
HAWAK-pillar:	No. 9894, No. 9895	
Flat gasket:	No. 3390, No. 3470	

Order no.	Version	MOP (PN)	Dimensions/DN						
			50	65	80	100	125	150	200
4000E3	short	16							
	EN 558 GR 14								
4700E3	long	16							
	EN 558 GR 15								
4010E3	short	25							
	EN 558 GR 14								
4710E3	long	25							
	EN 558 GR 15								
4060E3	to BS 5163 to AS 2638	16			*	*		*	*

\*in preparation

## Application examples



# E3 Gate valve

With flange DN 50 – 200, PN 10 | PN 16 | PN 25

No. 4000E3

No. 4700E3

No. 4010E3

No. 4710E3

No. 4060E3

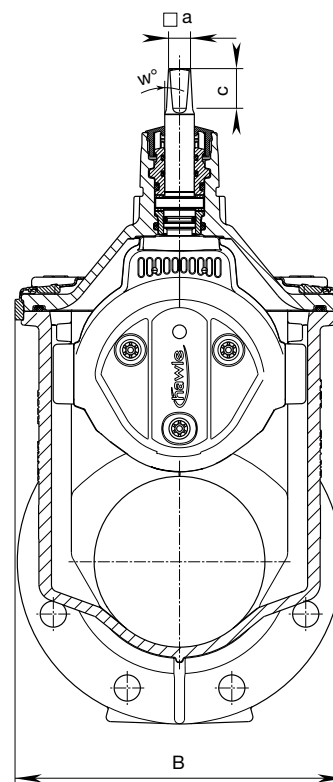
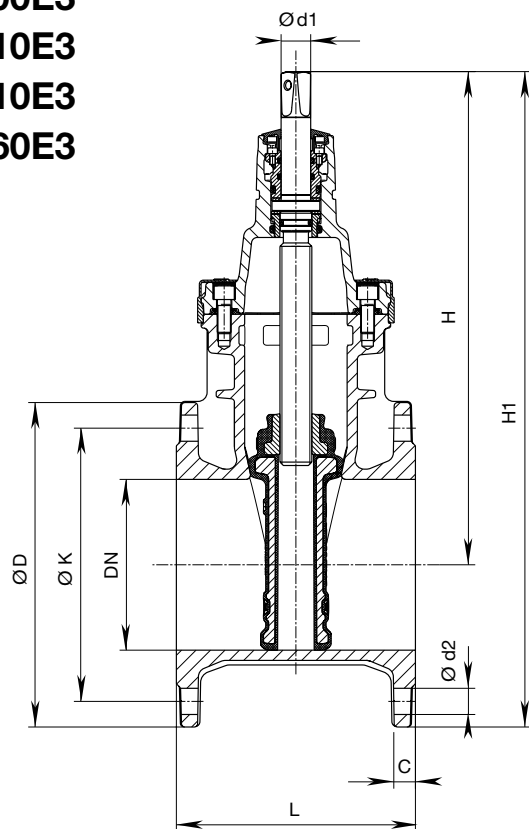

DN	MOP (PN)	Flange			Bolts			Spindle			Valve						Weight			
		ØD	C	ØK	Qty.	Thread	Ød2	a	c	w°	Ød1	H	H1	L short	L long	L BS 5163 AS 2638	B	short	long	BS 5163 AS 2638
50	10																	10,0	11,5	10,7
	16	165	19	125	4	M 16	19	14,8	33		20,5	234	316,5	150	250	178	143	10,0		
	25																			
65	10																	15,5	17,5	
	16	185	19	145	4	M 16	19	17,3	35		24	305	397,5	170	270		180	16,0		
	25				8															
80	10																	16,5	20,0	18,0
	16	200	19	160	8	M 16	19	17,3	38		24	312,5	412,5	180	280	203	180	18,0		
	25																			
100	10																	20,5	25,5	23,5
	16	220	19	180	8	M 16	19	19,3	39	3°	24	343	453	190	300	229	212	24,5		
	25	235		190		M 20	23					460								
125	10																	33,0	37,5	
	16	250	19	210	8	M 16	19	19,3	39		26	421	546	200	325		289	34,0		
	25	270		220		M 24	28					556								
150	10																	37,0	43,5	41,0
	16	285	19	240	8	M 20	23	19,3	39		26	433	576	210	350	267	289	47,0	49,0	
	25	300		250		M 24	28					583								
200	10				8													60,5	71,5	65,0
	16	340	20	295	12	M 20	23	24,3	49		30	541	711	230	400	292	356	67,0	79,0	
	25	360		310	12	M 24	28					721								

# E3 Gate valve

With flange DN 250 – 600, PN 10 | PN 16 | PN 25

## Design features

- Resilient seated gate valve with smooth straight-through bore
- Flanges sized in accordance with EN 1092-2, drilled according to  
EN 1092-2 | PN 10 standard (4000E3, 4700E3);  
EN 1092-2 | PN 16 from DN 200 (4000E3, 4700E3);  
EN 1092-2 | PN 25 (4710E3)  
Please specify on order - other standards on request
- Suitable for cleaning with a cleaning pig
- Suitable for operation by automatic actuators
- O-rings lip-seals replaceable under operating pressure up to DN 400
- Ball bearings in the spindle seating minimizes closing forces
- Easy to actuate without bypass and without power boost - even for 16 bar differential pressure
- For mounting a position indicator it is necessary to remove the centering flange and attach the adapter for position indicator

**Standard version:** without handwheel and extension spindle

**Design versions:**

for actuator:	No. 4000ELE3
with actuator:	No. 4000EME3
with position indicator:	No. 4000STE3
for seawater:	No. 4002E3, No. 4702E3

**Special versions:** on request  
- Bevel gearing

**No. 4000E3**

**No. 4700E3**

**No. 4710E3**

**No. 4060E3**



## Suitable accessories

**Suitable accessories:** see page A 2/2

Handwheel:		No. 7800
Extension spindles:	rigid	No. 9000E2/E3
	telescopic	No. 9500E2/E3
Surface boxes:	rigid	No. 1750
	telescopic	No. 2050
		No. 2051K
Valve actuator:		No. 9920
Adapter for actuator (E3 adapter):		No. 8630E3
Base plate:		No. 3481, No. 3482
Operating cap:		No. 2156, No. 2157
Extension spindle:		No. 7820, No. 7825
Bolts:		No. 8810, No. 8830, No. 8840
HAWAK-pillar:		No. 9894, No. 9895
Flat gasket:		No. 3390, No. 3470

Order no.	Version	MOP (PN)	Dimensions/DN						
			250	300	350	400	450	500	600
4000E3	short EN 558 GR 14	16							
4700E3	long EN 558 GR 15	16							
4710E3	long EN 558 GR 15	25							
4060E3	to BS 5163 to AS 2638	16							

# E3 Gate valve

With flange DN 250 – 600, PN 10 | PN 16 | PN 25

No. 4000E3

No. 4700E3

No. 4710E3

No. 4060E3

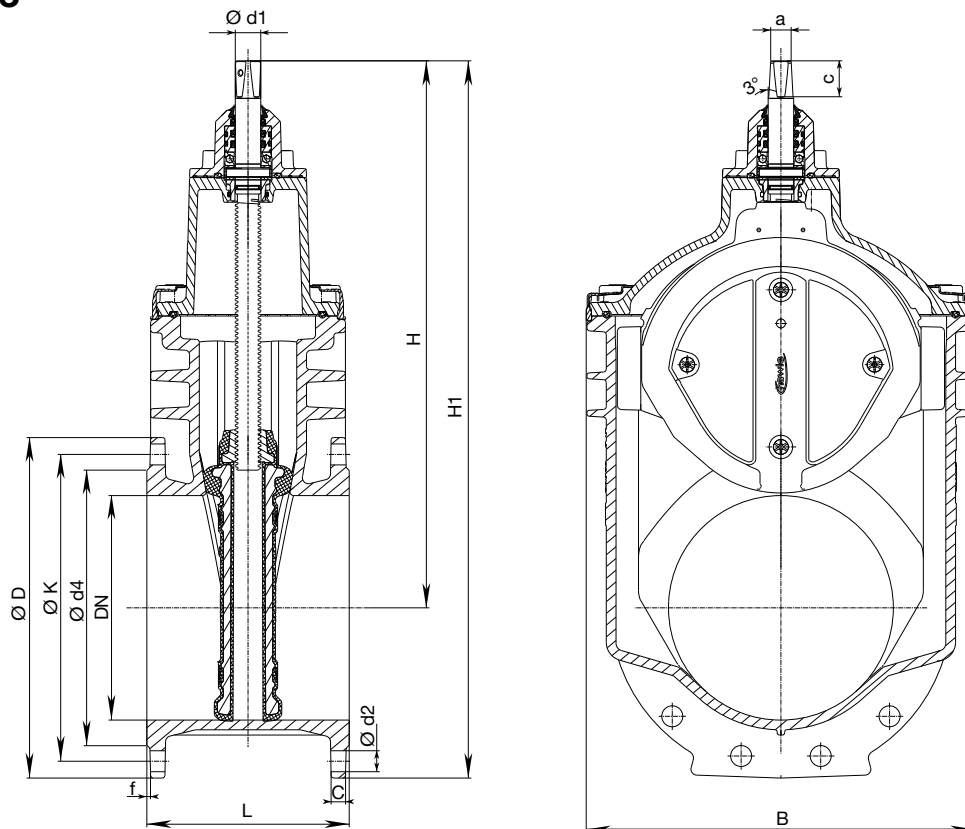

DN	MOP (PN)	Flange					Bolts			Spindle			Valve				Weight		
		Ø D	C	Ø K	Ø d4	f	Qty.	Thread	Ø d2	a	c	Ø d1	H	H1	L short	L long	B	short	long
250	10	400	22	350	319	3	12	M 20	23	27,3	48	34	649	849	250	450	436	98,5	114,5
	16	400	22	355	319	3	12	M 24	28	27,3	48	34	649	849	250	450	436	102,0	110,0
	25	425	24,5	370	330	3	12	M 27	31	27,3	48	34	649	862	250	450	436	102,0	136,0
300	10	455	24,5	400	367	4	12	M 20	23	27,3	48	34	731	958	270	500	520	151,0	169,5
	16	455	24,5	410	367	4	12	M 24	28	27,3	48	34	731	958	270	500	520	150,0	169,0
	25	485	27,5	430	389	5	16	M 27	31	27,3	48	34	731	973	270	500	520	150,0	196,0
350	10	520	26,5	460	427	4	16	M 20	23	27,3	48	34	816	1076	290		604	205,5	
	16	520	26,5	470	427	4	16	M 24	28	27,3	48	34	816	1076	290		604	205,5	
400	10	580	28	515	477	4	16	M 24	28	32,3	55	44	925	1215	310	600	687	266,0	310,0
	16	580	28	525	477	4	16	M 27	31	32,3	55	44	925	1215	310	600	687	266,0	310,0
450*	10	640	30	565	530	4	20	M 24	28	32,3	55	44	925	1261		650	687		328,5
	16	640	30	585	530	4	20	M 27	31	32,3	55	44	925	1261		650	687		328,5
500*	10	715	31,5	620	582	4	20	M 24	28	32,3	55	44	925	1296	350	700	800	471,0	367,0
	16	715	31,5	650	582	4	20	M 30	34	32,3	55	44	925	1296	350	700	800	471,0	367,0
500	10	715	31,5	620	582	4	20	M 24	28	36,3	66	50	1149	1507	350	700	800	471,0	530,0
	16	715	31,5	650	582	4	20	M 30	34	36,3	66	50	1149	1507	350	700	800	471,0	530,0
600	10	840	36	725	720	5	20	M 27	31	36,3	66	50	1306	1726	390	800	944	690,0	764,0
	16	840	36	770	720	5	20	M 33	37	36,3	66	50	1306	1726	390	800	944	690,0	764,0

\*Body DN400 – flange connection DN450 or 500