

Flange connections

For steel pipes, PN 16

Design features No. 7101

- For steel pipes according to EN 10220
- Flanges sized and drilled in accordance with EN 1092-2, PN 10 standard; EN 1092-2, PN 16 for DN 200 to DN 300 please specify on order - other standards on request
- The long draw of the fitting and the double chambered gasket result in the pressure being spread well back from the pipe end
- The resilience of the connection prevents tension in the pipe and minimises the danger of breakage

Assembly instructions

- Cut the pipe end straight, do not chamfer or moisten - push the flange onto the pipe and then push the gasket on

Double chamber flange adapter

No. 7101

Standard

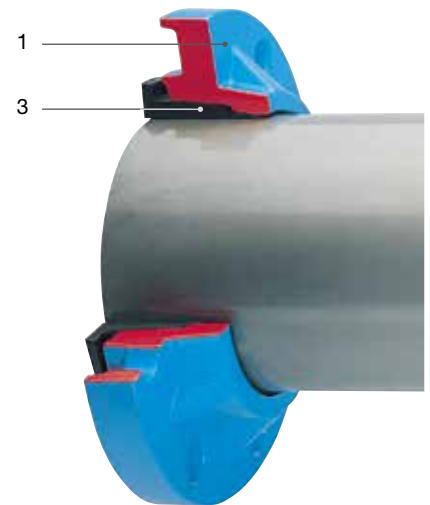

Design features No. 7601

- For steel pipes according to EN 10220
Flange sized and drilled in accordance with EN 1092-2, PN 10 standard; EN 1092-2, PN 16 for DN 200 to DN 250 please specify on order - other standards on request
- Simultaneous pipe restraint and sealing
- This avoids the need for pipe support and additional bolts to counter the effect of axial load and pressure. This connection can be easily dismantled at any time

Assembly instructions

- Assemble the flange with the sleeve gasket and pressure ring, and push onto the piece. Offer up the complete flange to the opposing flange, ensuring that the pressure ring projects approx. 10 mm over the end of the pipe. Cross tighten the nuts and bolts to make the connection. This fitting has the advantage that it can cope with a gap or an uneven cut that extends up to 15 mm from the opposing flange

Flange adapter

No. 7601

Restraint

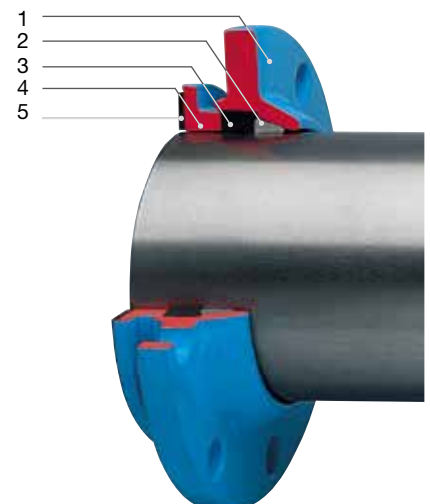

Material | Technical features

- 1 **Flange** made of ductile iron, epoxy powder coated
- 2 **Grip ring** hardened steel
- 3 **Sleeve gasket** made of elastomer
- 4 **Pressure ring** made of ductile iron, epoxy powder coated
- 5 **Seal** made of elastomer

Order No.	Version	MOP (PN)	Flange DN / Ø Pipe																
			40	50	50	60	65	80	80	100	100	100	125	150	150	200	250	250	500
			48	56-57	59-61	67	76	84	89	104-106	108	114	133	159	168	219	267	273	508
7101	Double chamber flange adapter, standard															*			*x
7601	Flange adapter, restrained	16										1				1			*x
0101	Spar flange, standard																		

Explanation: * also available in PN 16, * see page C 4/1

¹ Flanges with an extended hole circle are not suitable for use with fixed studs!

Flange connections

For steel pipes, PN 16

No. 7101 / 0101

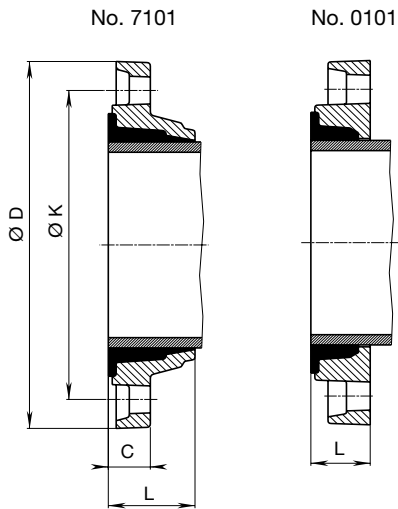

Flange DN	Ø Pipe	Ø D		Ø K	C		L		Bolts		Weight	
		7101	0101		7101	7101	0101	Quantity	Thread	7101	0101	
40	48		150	110			30		4	M 16		0,9
50	56-57	165		125	26	54			4	M 16		2,6
50	59-61	165		125	26	54			4	M 16		2,6
60	67		175	135			37		4	M 16		2,5
65	76	185		145	28	56			8	M 16		3,5
80	84		200	160			37		8	M 16		3,5
100	104-106		220	180			38		8	M 16		4,4
100	108	220	220	180	25	63	38		8	M 16	3,6	4,4
100	114	220		180	23	63			8	M 16	4,4	
125	133	250		210	33	64			8	M 16	6,8	
150	159		285	240			45		8	M 20		7,5
200	219	340		295	30	71			8	M 20	8,6	
250	267		400	350			48		12	M 20		14,5
500	508		690	620			76		20	M 24		50,9

No. 7601

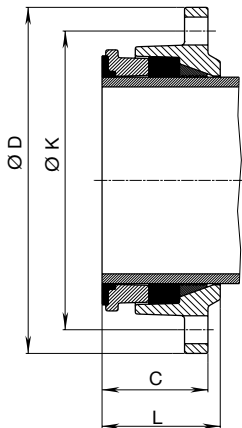

Flange DN	Ø Pipe	Ø D	Ø K	C	L	Bolts		Weight
						Quantity	Thread	
50	60	165	125	39	61	4	M 16	2,7
65	76	185	145	38	61	4	M 16	3,5
80	89	200	160	39	67	8	M 16	3,9
100	108	220	180	39	69	8	M 16	4,7
100	114	220	180	44	69	8	M 16	4,4
125	133	250	210	39	69	8	M 16	5,7
150	159	285	240	49	73	8	M 20	7,8
150	168	285	240	49	73	8	M 20	7,5
200	219	340	295	52	81	8	M 20	10,5

Design features

- From 4 hole to 8 hole
- Made of ductile iron, epoxy powder coated
- PN 16

DN	MOP (PN)	Length	Weight
80	16	42	5,0

Transition flange

No. 0800

DN 80

