

BAIO - Fittings

BAIO EMS piece without gaskets

Design features

- BAIO spigot / wide range socket
- For sanitation with wide range socket
- Long socket with slipover length

DN	Ød	MOP (PN)	L	E	Adjustment area S	Weight
80	84 – 105	16	740	117	414 – 426	16,80
100	104 – 132		725	110	374 – 395	19,00
150	154 – 192		774	120	361 – 390	28,00
200	192 – 232		778	140	355 – 382	43,50

BAIO EMS piece “MULTI/JOINT” No. NL44MJ

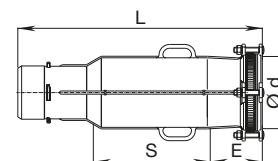

Design features

- BAIO spigot / Synoflex multi-range socket
- For sanitation with wide range socket
- Long socket with slipover length

DN	Ød	MOP (PN)	L	E	Adjustment area S	Weight
200	230 – 260	16	880	149 – 161	420 – 450	58,00
250	265 – 310		885	155 – 167	420 – 450	65,50
300	313 – 356		920	161 – 180	450 – 490	99,50

BAIO EMS piece “Synoflex” No. NL44SY

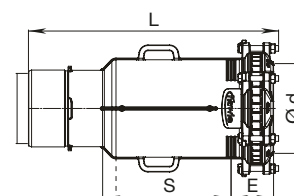

Design features

- BAIO spigot / screw socket
- For sanitation with screw sockets
- Long socket with slipover length

DN	Ød	MOP (PN)	L	E	Adjustment area S	Weight
80	98	16	555	85	275	13,30
100	118		580	90	280	14,50
125	144		615	90	290	19,60
150	170		615	95	285	24,00
200	222		695	100	350	35,40
250	274		730	106	379	55,00
300	326		750	110	397	71,00

BAIO EMS piece (cut-in socket fitting) No. NL44

