

**Montageanleitung**  
**Hausanschluss-Schieber Hawle-Fit**

**Instruction**  
**Hawle Fit Service valve**



# Hawle-FIT

Instruction — Fittings / Valves

Medium potable water

for PE pipes  $\varnothing$  d 25 - d 63 up to PN 16

hawle

## ASSEMBLY:

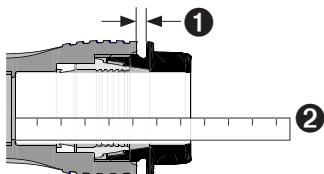

Bevel the pipe with  
chamfering tool  
No. 6000

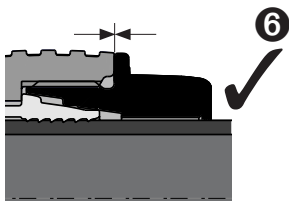
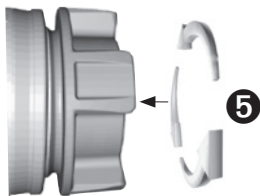
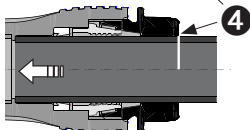
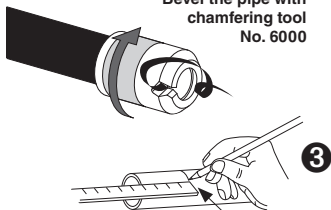

for low pressure with support liner

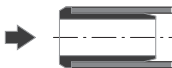

For PE pipes SDR 17 we recommend  
a support liner Hawle Cat.-No. 6021

## DISMANTLING:

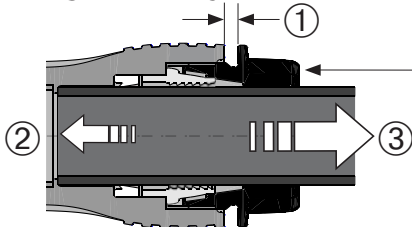

Without tools!  
Grip ring opens  
automatically

# Hawle-FIT

Einbauanleitung – Fittings / Schieber  
Medium Trinkwasser

für PE-Rohre  $\varnothing$  d 25 - d 63 bis PN 16

hawle

## MONTAGE:

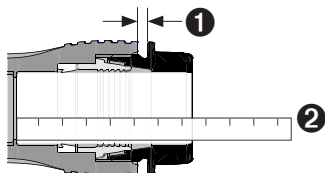

Rohr anschrägen  
mit Rohrfräser  
Kat.-Nr. 6000

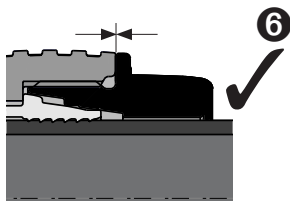
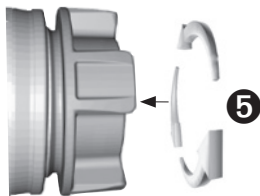
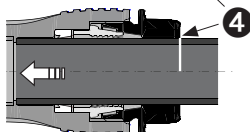
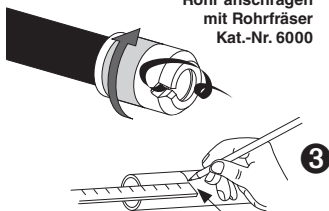

bei Unterdruck mit Stützbüchse



Für PE-Rohre SDR 17 empfehlen wir die  
Verwendung einer Stützbüchse Hawle Kat.-Nr. 6021

## DEMONTAGE:

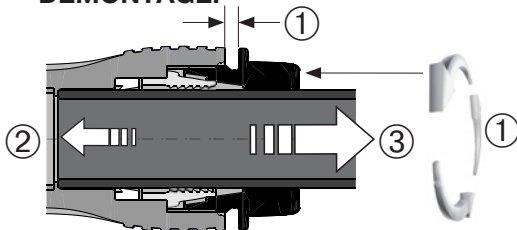

Ohne Werkzeug!  
Klemme öffnet  
selbsttätig

# Hawle-FIT

Instruktion — Kopplingar / Ventiler  
För PE rör  $\varnothing$  d 25 - d 63 upp till PN 16



## MONTERING:

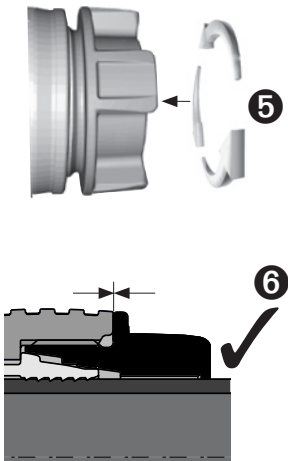
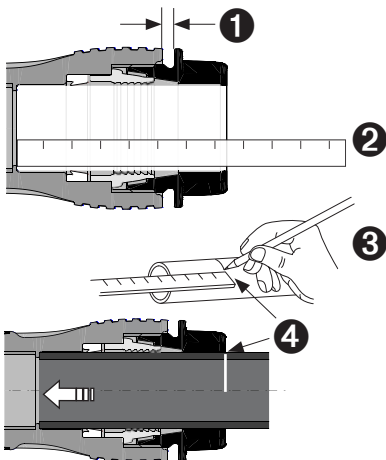

## DEMONTERING:

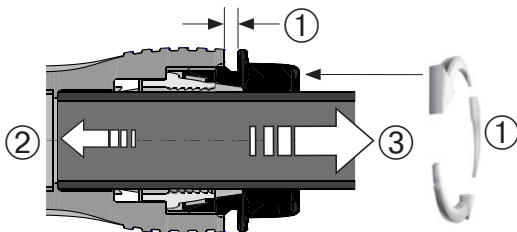

Utän verktyg!  
Klämring öppnas  
automatiskt.

04.2018 | Art.-No.: 5017099